

LORAWAN CURRENT INPUT SENSOR



SKU: WSLRW-MA

LoRaWAN 0-20mA CURRENT INPUT SENSOR WSLRW-MA



WSLRW-MA-H1.PNG

WSLRW-MA is the LoRaWAN wireless sensor with one channel to measure 0-20mA DC current from Process instruments like Pressure transmitter, Temperature transmitter, Level transmitter, Flow meters, Analyzers... at very low voltage drop. With Ultra-low-power design and smart firmware allow the sensor can last up to 10 years with 2 x AA batteries (depends on configuration). The sensor will transmit data in the kilo-meters distance to LoRaWAN gateway, any brand on the market.



LORAWAN COMMUNICATION

LoRaWAN communication standard to allow sensor connect to any LoRaWAN Gateway on the market.



10 YEAR BATTERY

Ultra-low power sensing technology from Daviteq with Ultra-low power wireless technology allow the sensor can last up to 10 years with a 2 x AA Type battery.



PRE-CALIBRATED

Sensors are pre-calibrated at factory to deliver high accuracy and quick installation



IP68

For both indoor and outdoor applications

LoRaWAN SENSOR CURRENT INPUT CONNECT WITH 4-20mA LEVEL SENSOR



4-20mA
Loop powered

WSLRW-MA-H2.PNG

DAVITEQ TECHNOLOGIES INC

No.11 Street 2G, Nam Hung Vuong Res., An Lac Ward, Binh Tan Dist., Ho Chi Minh City, Vietnam

+84.28.6268.2523 / 6268.2524

info@daviteq.com

www.daviteq.com

JAN-2021 | Doc No: WSLRW-MA-DS-EN-10

1/4

SPECIFICATION

SENSORS SPECIFICATION:	
Measuring range	0 .. 20mA
Accuracy	0.05% of span
Resolution	1/3000
Temperature drift	< 50ppm
Sensor port connector	M12-Male, 4-pin A-coding
LoRaWAN SPECIFICATION:	
Data rate	250bps .. 5470bps
Antenna	Internal Antenna 2.67 dBi
Battery	02 x AA size 1.5VDC, battery not included
RF Frequency and Power	860..930Mhz, +14 .. +20 dBm, configurable for zones: EU868, IN865, RU864, KR920, AS923, AU915, US915
Protocol	LoRaWAN, class A
Data sending modes	Interval time and when alarm occurred
RF Module complies to	ETSI EN 300 220, EN 303 204 (Europe) FCC CFR47 Part15 (US), ARIB STD-T108 (Japan)
Vietnam Type Approval	
Working temperature	-40oC..+60oC (with AA L91 Energizer)
Dimensions	H180xW50xD40
Net-weight	250 grams
Housing	Polycarbonate & POM plastic, IP67

**LoRaWAN SENSOR CURRENT INPUT
CONNECT WITH 4-20mA SOIL MOISTURE SENSOR**



WSLRW-MA-H3.PNG

**LoRaWAN SENSOR CURRENT INPUT
CONNECT WITH 4-20mA PRESSURE SENSOR**



WSLRW-MA-H4.PNG

DAVITEQ TECHNOLOGIES INC

No.11 Street 2G, Nam Hung Vuong Res., An Lac Ward, Binh Tan Dist., Ho Chi Minh City, Vietnam

+84.28.6268.2523 / 6268.2524

info@daviteq.com

www.daviteq.com

JAN-2021

| Doc No: WSLRW-MA-DS-EN-10

2/4

LoRaWAN NETWORK



This wireless network can connect any kind wireless sensors:

- * RELAY OUTPUTS FOR VALVE/PUMP CONTROLS;
- * AIR HUMIDITY/TEMPERATURE SENSOR;
- * CO2 SENSOR;
- * AMBIENT LIGHT SENSOR;
- * ...ETC

WSLRW-MA-H5.PNG

DIMENSION DRAWING OF WIRELESS SENSOR (Unit: mm)

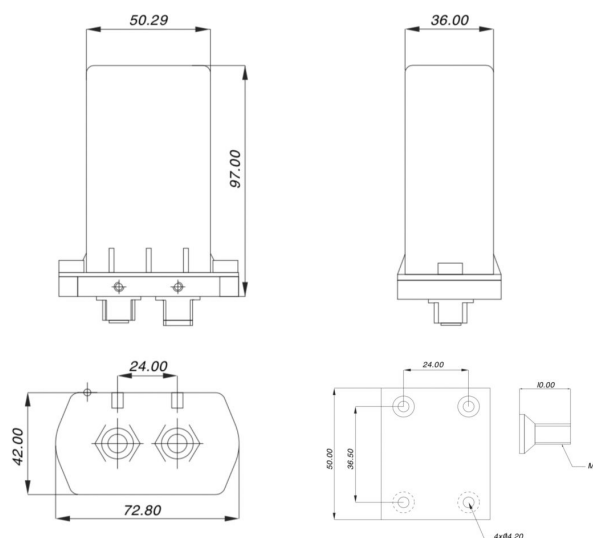

WSLRW-MA-H6.PNG

WIRING FOR LoRaWAN SENSOR WITH CURRENT INPUT

CASE 1 - WORK WITH LOOP POWERED SENSOR

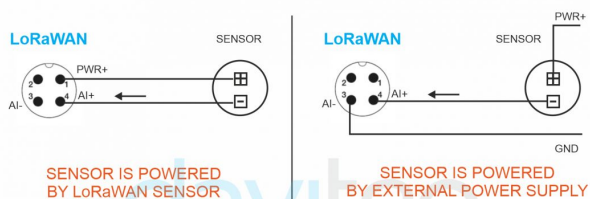

CASE 2 - WORK WITH NON - LOOP POWERED SENSOR

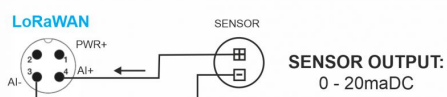

WSLRW-MA-H7.PNG

RECOMMENDED BATTERIES

E91 AA Alkaline battery



-18 .. + 60 oC working temperature
10-year shelf life
3000 mAh Capacity
Price: 1X

L91 AA Lithium battery



-40 .. + 60 oC working temperature
20-year shelf life
3500 mAh Capacity
Price: 3.5X

WSLRW-MA-H8.PNG

ORDERING INFORMATION

ITEM CODE	DESCRIPTIONS
WSLRW-MA-9-10	Wireless LoRaWAN 1-Channel 0-20mA DC Current Input Sensor, Internal antenna, accuracy 0.05%, M12 connector, Type AA battery 1.5VDC, IP67, 900-930 Mhz for KR920, AS923, AU915, US915
WSLRW-MA-8-10	Wireless LoRaWAN 1-Channel 0-20mA DC Current Input Sensor, Internal antenna, accuracy 0.05%, M12 connector, Type AA battery 1.5VDC, IP67, 860-870 Mhz for EU868, IN865, RU864
ACCESSORIES	
2M-MM12CAB4x0.25	M12 4pin Male assembly connector with Soldering terminals and coding A and Control Cable Cu/PVC/OS/PVC 4x0.25mm2, L=2m, Rohs, Shield 80%
2M-FM12CAB4x0.25	M12 4pin Female assembly connector with Soldering terminals and coding A and Control Cable Cu/PVC/OS/PVC 4x0.25mm2, L=2m, Rohs, Shield 80%
5M-MM12CAB4x0.25	M12 4pin Male assembly connector with Soldering terminals and coding A and Control Cable Cu/PVC/OS/PVC 4x0.25mm2, L=5m, Rohs, Shield 80%
5M-FM12CAB4x0.25	M12 4pin Female assembly connector with Soldering terminals and coding A and Control Cable Cu/PVC/OS/PVC 4x0.25mm2, L=5m, Rohs, Shield 80%
10M-MM12CAB4x0.25	M12 4pin Male assembly connector with Soldering terminals and coding A and Control Cable Cu/PVC/OS/PVC 4x0.25mm2, L=10m, Rohs, Shield 80%
10M-FM12CAB4x0.25	M12 4pin Female assembly connector with Soldering terminals and coding A and Control Cable Cu/PVC/OS/PVC 4x0.25mm2, L=10m, Rohs, Shield 80%
Notes	*Purchase M12-Male cable to power the sensor