

LORAWAN NH3 AND H2S SENSOR FOR TOILET ODOR



SKU: WSLRW-G4F-NH3

LoRaWAN AMMONIA TOILET SENSOR
WSLRW-G4F-NH3



WSLRW-G4F-NH3-H1.JPG

WSLRW-G4F-NH3 is a LoRaWAN sensor with a built-in advanced gas sensor to measure the concentration of Ammonia NH3 and H2S to help assess odors in the Toilet. A special design increases the sensor's sensitivity, even though it is mounted on the ceiling at a distance of up to 2.6m. The sensor has an ultra-low-power design and smart firmware that allows the sensor to run on 2 x 1.5VDC AA batteries for 2-5 years with 15 minutes of updating. The sensor supports all LoRaWAN frequency bands on over the World.

Typical application: Odor monitoring in private or public restrooms, toilets, and WC, helps to manage optimal cleaning staff.



HIGH SENSITIVITY

Special design to get high sensitivity even the sensor is mounted on ceiling up to 2.6m



ANTI-TAMPERING

Allow mounting the sensor on ceiling or high wall to prevent tampering



LORAWAN COMPLIANCE

LoRaWAN Class A, V1.0.3, all frequency bands



ULTRA-LOW-POWER DESIGN

Allow the sensor to run in 2-5 years with 2 x AA batteries



WSLRW-G4F-NH3-H2.JPG

DAVITEQ TECHNOLOGIES INC

No.11 Street 2G, Nam Hung Vuong Res., An Lac Ward, Binh Tan Dist., Ho Chi Minh City, Vietnam

+84.28.6268.2523 / 6268.2524

info@daviteq.com

www.daviteq.com

JAN-2023 | Doc No: WSLRW-G4F-NH3-DS-EN-10

1/4

SPECIFICATION

Sensor type	High sensitive electrochemical type sensor, built-in auto-sampling mechanism
NH3 range	0..100 ppm (or equivalent 0..285.7 ppm H2S)
NH3 tolerance limit	200 ppm
Repeatability / Resolution / Stability per month	< 3% of reading / 0.1 ppm / < 1% of reading/month
Zero-point stability	+/- 0.3 ppm
Ambient pressure	101.3 Kpa +/- 10%
Sensor life	2 years, in clean air
Working temperature	-10 .. + 50°C
Working humidity	15.. 90% RH
LoRaWAN SPECIFICATION	
SP factors	SF7..SF12 (with internal Antenna 2.67 dbi)
Battery	02 x AA size 1.5VDC, battery not included
RF Frequency and Power	860..930Mhz, +14 .. +20 dBm, configurable for zones: EU868, IN865, RU864, KR920, AS923, AU915, US915
Protocol	LoRaWAN, class A, V1.0.3
Data sending modes	Interval time and when the alarm occurred
Configuration	via Downlink or Offline cable (software is free)
RF Module	complies to ETSI EN 300 220, EN 303 204 (Europe) FCC CFR47 Part15 (US), ARIB STD-T108 (Japan)
Working temperature	-40oC..+60oC (with AA L91 Energizer)
Case/protection grade	ABS, indoor use, do not spray water directly on the device
Dimensions/Weight	Diameter 95mm x Height 40mm / < 250g

INTERFERENCE GASES

Interfering Gas	Concentration [ppm]	Reading [ppm]
Cl ₂	20	-55
CO	300	0
CO ₂	20000	0
H ₂	200	0
H ₂ S	20	7
NO	20	-1
NO ₂	20	-20
SiH ₄	10	0
SO ₂	20	-7

WSLRW-G4F-NH3-H3.JPG

LoRaWAN NETWORK

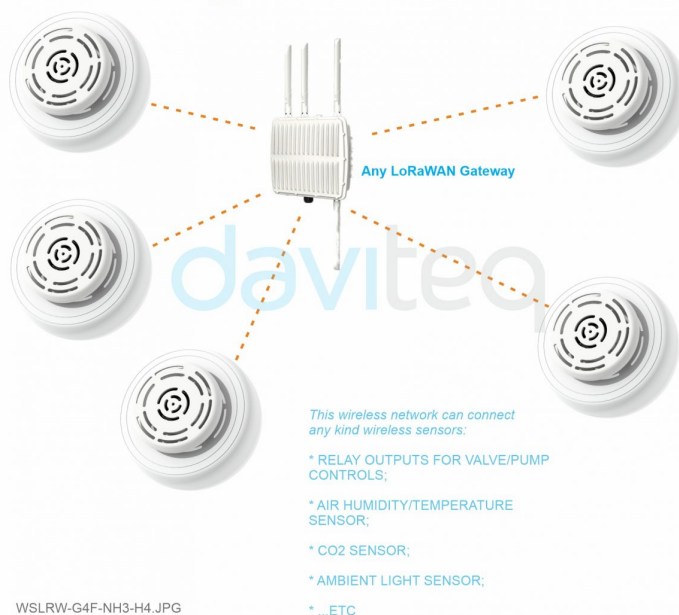

WSLRW-G4F-NH3-H4.JPG

DIMENSION DRAWING OF WIRELESS SENSOR
(Unit: mm)

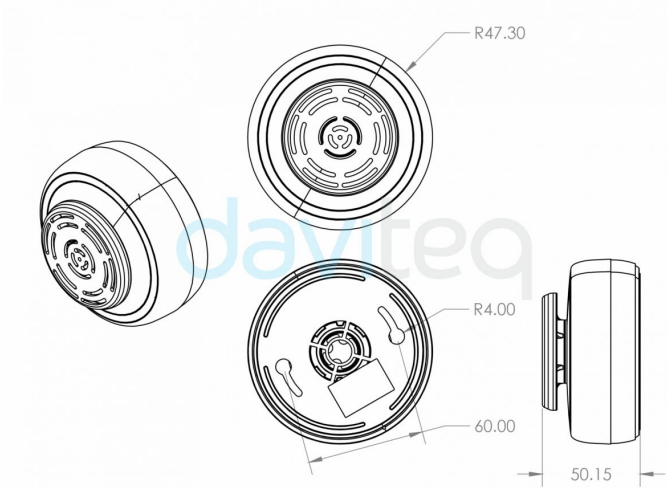

WSLRW-G4F-NH3-H5.JPG

RECOMMENDED BATTERIES FOR LoRaWAN SENSOR

E91 AA Alkaline battery



- 18 .. + 60 oC working temperature
- 10-year shelf life
- 3000 mAh Capacity
- Price: 1X

WSLRW-G4F-NH3-H6.JPG

L91 AA Lithium battery



- 40 .. + 60 oC working temperature
- 20-year shelf life
- 3500 mAh Capacity
- Price: 3.5X

ORDERING INFORMATION

WSLRW-G4F-NH3-100-01	LoRaWAN Gas Sensor, 4-Seri, Ceiling mount type, NH3 Gas, 100PPM range
----------------------	---